



Stainless

Overlay

## 3036BVWC

3000 SERIES

### FEATURES

#### PERFORMANCE

- Wine bottle capacity up to 31 bottles (.75L)
- Digitally controlled dual-zone convection cooling system
- Refrigeration capacity of 3.6 cubic feet
- Bottle/can capacities: 60 12-oz bottles or 127 12-oz cans
- U-Select™ Control: Integrated OLED display with intuitive user interface ergonomically located on top of door
- Beverage Mode: 38° to 65°F, Sparkling Wine Mode: 38°- 50°F, White Wine Mode: 45°- 55°F, Red Wine Mode: 55°- 65°F
- U-Select™ Control provides 4 distinct settings designed to provide precise refrigeration and maximize preservation
- Convection Cooling Technology
- Sabbath / Black-Out mode
- UL Residential Listing

#### INTERIOR / EXTERIOR

- 2 wine racks will fit larger diameter wine bottles, including Champagne bottles
- Black interior with LED theater lighting optimizes elegant display
- Solid beech wood trimmed, full-extension black vinyl coated wine racks allow for full access to stored wines
- LowE coated, argon gas filled thermopane glass door provides protection from harmful UV rays and added insulating energy efficiency
- Robust, concealed and covered hinges with built-in door stop and closer
- Three fully adjustable tempered glass shelves with 11 positions optimize storage space for a wide variety of options
- Convenient crisper drawer comes in handy to store smaller items and keep them fresh

#### INTEGRATION

- Standard commercial stainless steel handle is interchangeable with professional handle option
- Adjustable toe-kick - front to back and up and down allows for seamless installation
- Front adjustable rear leveling legs greatly eases installation
- Allow a 2-1/2" clearance on hinged side for 90° door opening when installed adjacent to a wall (for stainless steel model)
- Allow 1/4" width overall for proper installation (see backside for details)
- No additional clearance around sides, top or rear of unit is needed for ventilation



2 wine racks will fit larger diameter wine bottles, including Champagne bottles



Adjustment and configuration of shelves allows for storing taller items

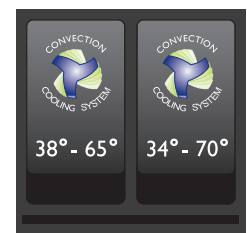

Dual Zone System featured in 3036BVWC

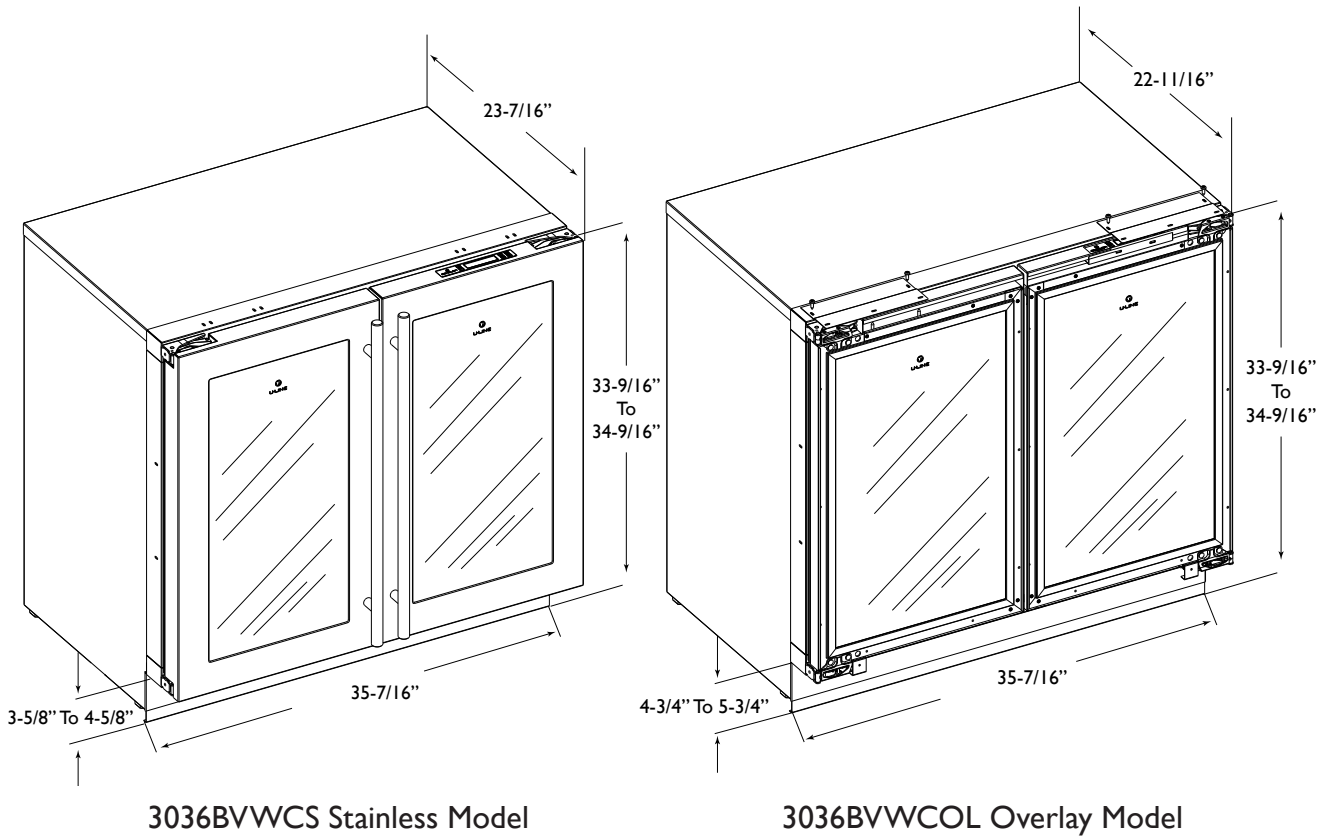

3036BVWCS Stainless Model

3036BVWCOL Overlay Model

**DIMENSIONS AND SPECIFICATIONS**

**OVERALL DIMENSIONS**

Height	33-9/16" (85.2)
Width	35-7/16" (90)
Depth	23-7/16" (60)
With stainless steel handle	25-5/16" (64.3)

**Shipping weight:**

Stainless model	231 lbs (104.8 kg)
Overlay model	219 lbs (99.3 kg)

Running amps	2.4
Amps pertain to voltage rating	110/115 Volt, 60 Hz

**Capacities:**

Wine bottle storage (0.75L)	Up to 62
Refrigerator volume	3.6 Cu Ft

3036BVWC	
Stainless	U-3036BVWCS-00
Overlay	U-3036BVWCOL-00

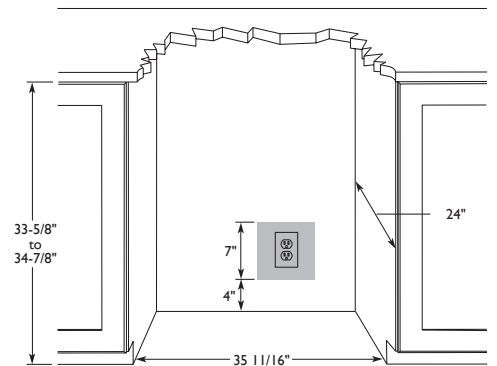

Please visit [www.u-line.com](http://www.u-line.com) for installation guide.

All specifications are subject to change without notice.

